

HOUSE TYPE B5.3

END OF TERRACE - 3 BEDROOM HOUSE [PART V]

GROUND FLOOR 47.2 m²
 FIRST FLOOR 45.0 m²
TOTAL 92.2 m² / 992 ft²

PROPOSED MATERIALS

ROOF: SELECTED BLUE / BLACK TILE OR SIMILAR APPROVED
 WALLS: PAINTED RENDER / BRICK WHERE INDICATED
 CANOPY: ZINC OR SIMILAR APPROVED
 WINDOWS: GREY OR APPROVED COLOUR
 DOORS: HARDWOOD / PVC TO SELECTED COLOUR

©THIS DRAWING IS COPYRIGHT
 THIS DRAWING IS FOR PLANNING PURPOSES ONLY

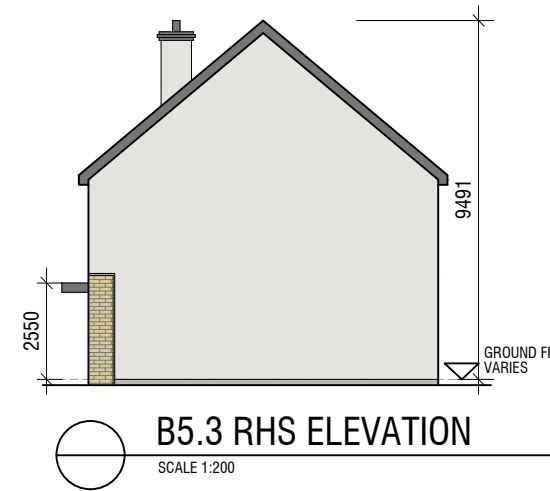
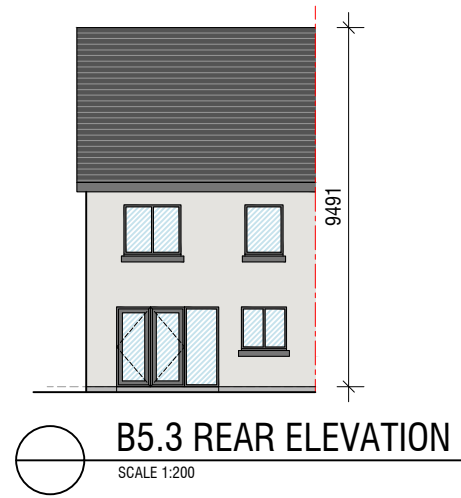
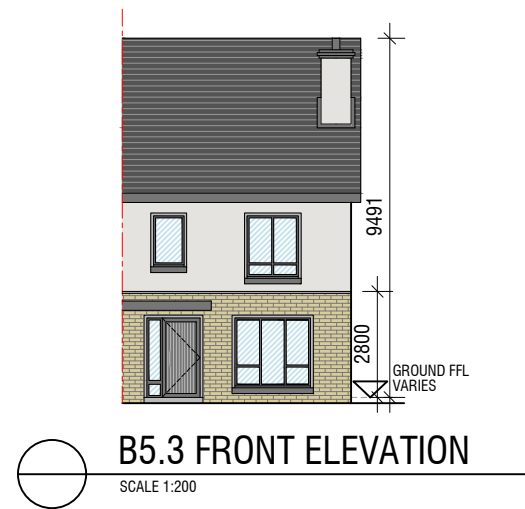
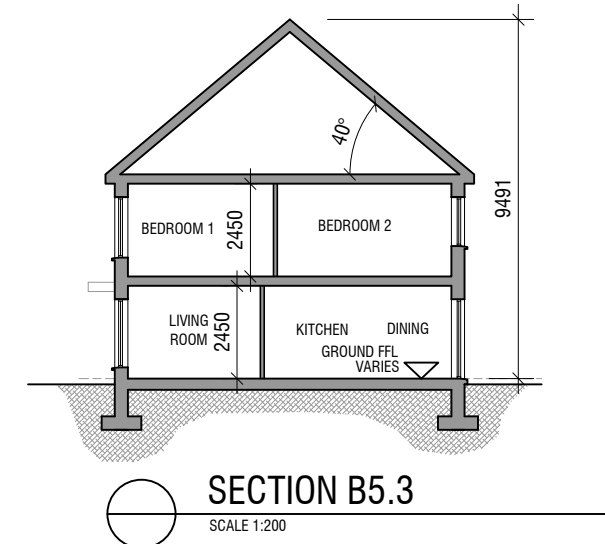
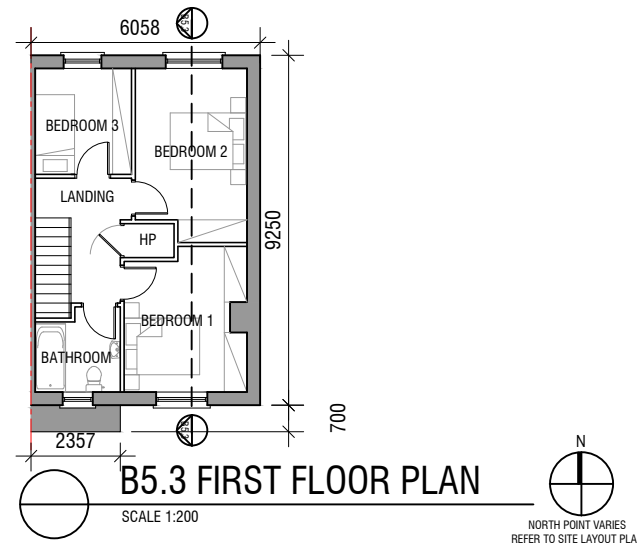
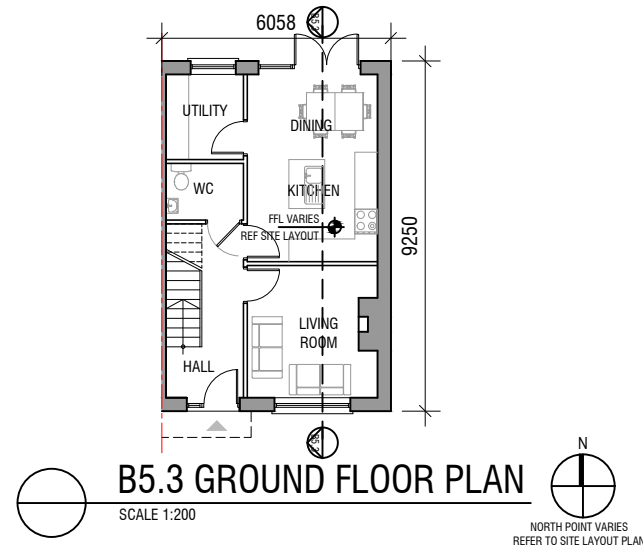

REV.:	DATE:	DRWN.:	DESCRIPTION:	INT:

GCA
GERALDINE COUGHLAN
 ARCHITECTS

Ard-Na-Greine, Enniskeane, Co. Cork 086-8259794 info@gca.ie



PROJECT: RESIDENTIAL DEVELOPMENT, GRANGE, DOUGLAS, CORK		JOB NO: 16090	
DRAWING: HOUSE TYPE B5.3 3 BED TERRACED (PART V)	BD	CLIENT: WESTBROOK	DRAWING NO: B5.3
SERIES: PLANNING	SCALE: 1:200	A3	
DATE: 12/11/2018			